

PAROC Cortex tapes

PAROC Cortex tape (XST 022) & PAROC Cortex corner tape (XST 021)
 PAROC Cortex black tape (XST 042) & PAROC Cortex black, corner tape (XST 041)



PAROC Cortex tape (XST 022) is used on the outside of the building for gluing and sealing diffusion-open or tight underlays on pitched roofs and facades.

Cortex tape is made of a highly UV-resistant fleece foil composite with a polyacrylate adhesive. The tape has very good initial and permanent adhesion, very good surface adhesion, and excellent aging resistance. The tape can be painted or plastered.

The task of the tape is to seal the seams and joints of the wind protection layer to prevent wind and rain from entering the wall and roof structures. PAROC Cortex tape seals all known roof and facade membranes on closed and slightly rough surfaces outdoors. The tape adheres very firmly to wood, brick, and non-abrasive surfaces. Cortex tape also works as a repair tape to repair small damages or cracks in the membranes.

PAROC Cortex corner tape (XST 021) is a wide tape with adhesive strips on both outer edges, from which the tape can be attached between two separate surfaces. Corner tape is used, e.g., in sealing the outer corners of the building and the visible insulation surfaces in the facade openings.

PAROC Cortex tape is permanently resistant to moisture and UV radiation for 4 months in direct sunlight.

APPROVALS:

Emission certificate Emissioncode EC1 Plus

APPLICATION:

Building envelope; sealing diffusion-open or tight underlay membranes on pitched roofs and facades

PACKAGE / STORING:

Carton package. Storing in dry space at a temperature of +5 to +25 °C, protected from UV radiation.

DIMENSIONS

Product code	width x length	packing	color	EAN 64380
PAROC Cortex tape (XST 022)	60 mm x 50 m	1 roll	white, black text	8566434
PAROC Cortex tape (XST 022)	60 mm x 50 m	10 rolls / carton	white, black text	8566450
PAROC Cortex corner tape (XST 021)	350 mm x 25 m	4 rolls / carton	white corner tape	8539721
PAROC Cortex black tape (XST 042)	60 mm x 50 m	10 rolls / carton	black	8566442
PAROC Cortex black, corner tape (XST 041)	310 mm x 25 m	4 rolls / carton	black corner tape	8550682



INSTALLATION

Seal all PAROC Cortex, Cortex One, Trio slab, or PAROC wind protection membrane seams, holes, and joints with age-resistant PAROC Cortex tape. Wider PAROC Cortex corner tape is installed, e.g., in window openings and outer corners to protect exposed wool surfaces. The corner tape has two adhesive strips on both edges of the product.

The outer corner can also be protected with wind protection insulation covering, by cutting the stone wool out and bending the insulation coating over the corner. In this case, tightness can be ensured with a narrower Cortex tape.

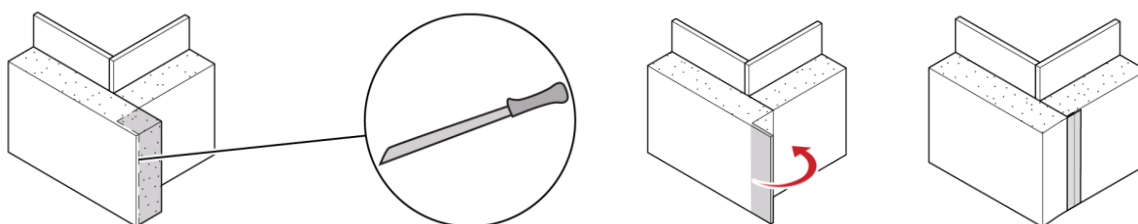

Installation temperature range is -10 °C to +40 °C. Taped surfaces must be grease-free and dust-free. The temperature range in use is -40 °C to +80 °C.

The tape adheres very firmly to wood, non-sanding bricks, and clean and possibly pre-primed concrete surfaces.

Consumption: PAROC Cortex and PAROC Cortex pro: approx. 1.5 m/m². PAROC Cortex One: approx. 2.5 m/m²

TECHNICAL PARAMETERS

Property	value	according to
Mechanical properties		
Tensile strength, EN ISO 29864	≥ 50 N/ 25 mm	
Elongation at break, EN 29864 (%)	20 %	
Adhesion, EN 29864	≥ 35 N/ 25 mm	
Moisture properties		
S _d -value	45 m	
Stability	Temperature-stable up to +120 °C	
End of life	Can be used as energy waste	

ACCESSORIES

- PAROC Cortex-membrane (XMW 068)
- Wind protection membrane WALKI Wall Breath 65 (XMW 065)

